

Alpina Acrylic Stand Off Frames

Acrylic Stand Off Frames provide a modern, professional, durable method for displaying graphics. Your graphic is easily sandwiched between the Acrylic panels, on positioning lines etched into the acrylic, so centering your graphic is simple. We are the only acrylic frame that offers this lasered positioning feature.

We provide the aluminum mounting hardware that securely grips the acrylic sections together (in Brushed Stainless or Jet Black). Your graphic or artwork is stylishly highlighted and blends perfectly into corporate, retail, restaurant, and any other locations. Made in Chicago on our new laser machine so we able to complete your etching projects, no matter how straightforward or intricate.

Here are some recent applications:

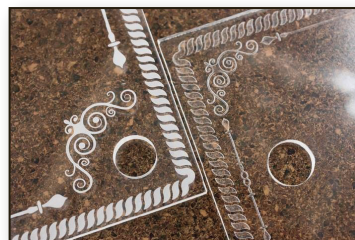
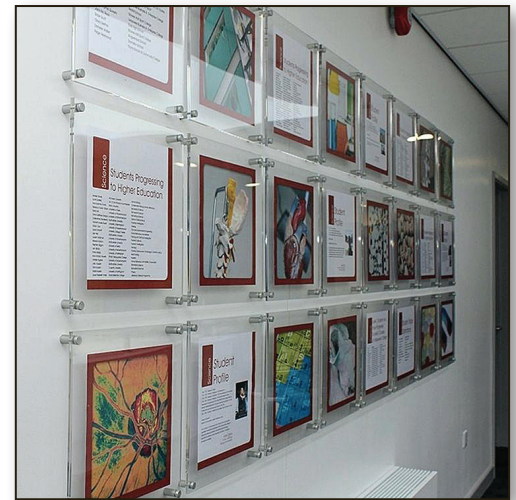

Alpina Manufacturing
6460 W. Cortland Street • Chicago, IL 60707
Tel: 1-800-915-2828 • Local Tel: 1-773-202-8887
sales@fastchangeframes.com
fastchangeframes.com • bannergrip.com



Acrylic Wall Stand-off Frame Installation Sheet

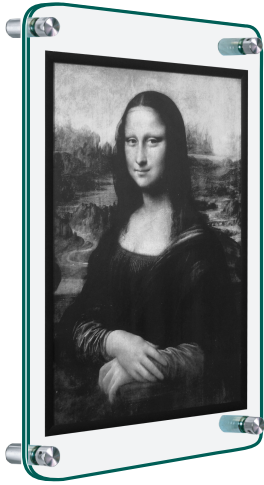

Features of this frame:

- Laser etched corner marks on rear panel for easy and level positioning of your graphic. No other frame offers this.
- Removable tacky tape pre-installed to hold your poster in place
- Radius corners, no sharp corners sticking out
- Precision laser cut, not by saw, we can laser any shapes, round, oval, complex
- We can also custom etch logos and names on the acrylic face
- Beautiful, professional presentation of your graphics
- Made in the USA !

Contents

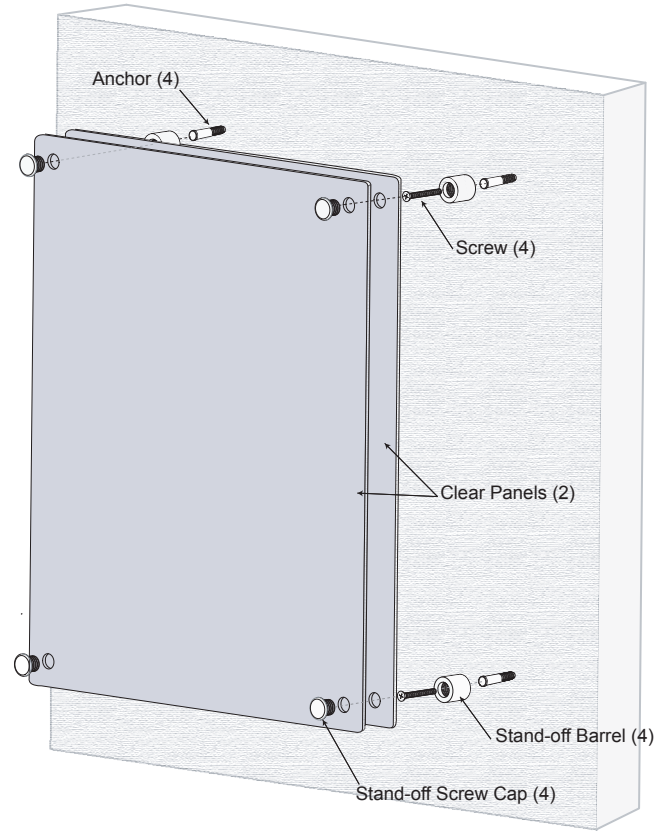
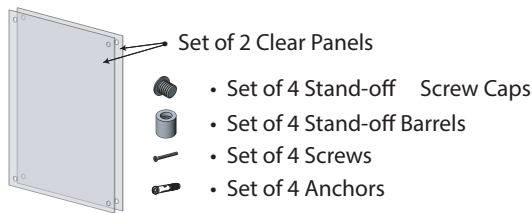

Note: depending on the frame size, each unit may take 4 or 6 standoffs.

Step 1. Leave masking on. Using a level, take the rear acrylic panel that has the positioning marks and position level on your wall. Trace circles in the 4 holes to mark for the screws.

Step 2. For plastic anchors, drill a 3/16" diameter hole in the center of the 4 traced holes and press in the anchor.

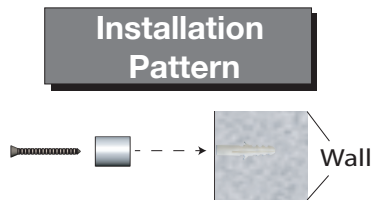

Step 3. Insert the screw into the standoff base and screw into the anchor on the wall. In case you mounted standoffs slightly off, no worries, we've made the holes in the acrylics slightly oversized to accommodate any errors.

Step 4. Before removing the masking, take a damp cloth, preferably microfiber, and wipe edges and masking on both sides of the acrylic before removing. This will remove a lot of the static that attracts dust. Next remove the masking from both sides of the acrylics.

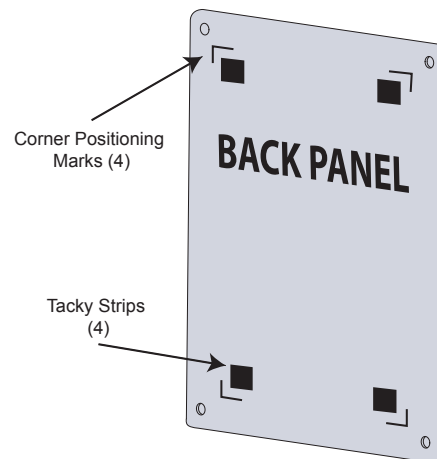
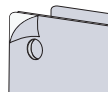

Step 5. Affix your graphic to the rear acrylic panel after you've peeled off the liner from the tacky tape, to hold graphic in place. We've etched 4 "corner" positioning marks for easy leveling and placement of your graphic on the back panel.

Step 6. Mate up both panels and screw caps into the bases on the wall.

You're all set for a super nice display !